

# Mukwonago Community Library Toniebox Setup Guide

**To use this Toniebox it first needs to be connected to Wi-Fi. This is how to connect your Toniebox to a Wi-Fi network:**

1. Navigate to [my.tonies.com/wifi](https://my.tonies.com/wifi) on your smartphone or computer.

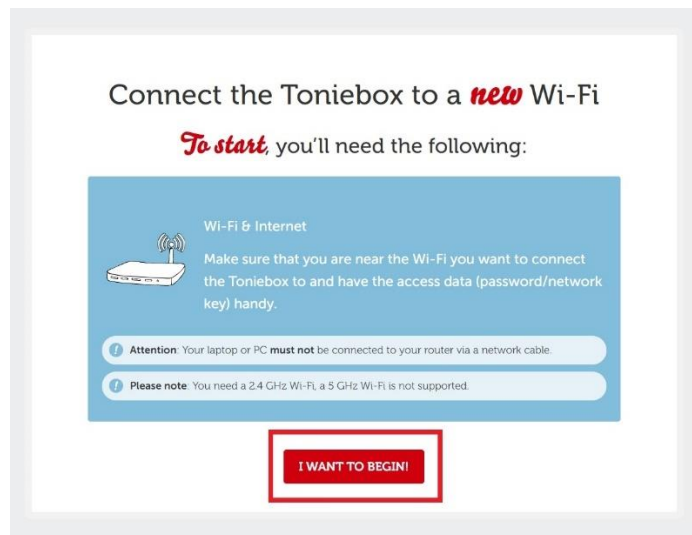

2. Enter your Toniebox ID. This is the 8 digit ID that can be found on the bottom of your Toniebox. Once you have entered your Toniebox ID, click on 'Great, go ahead'.

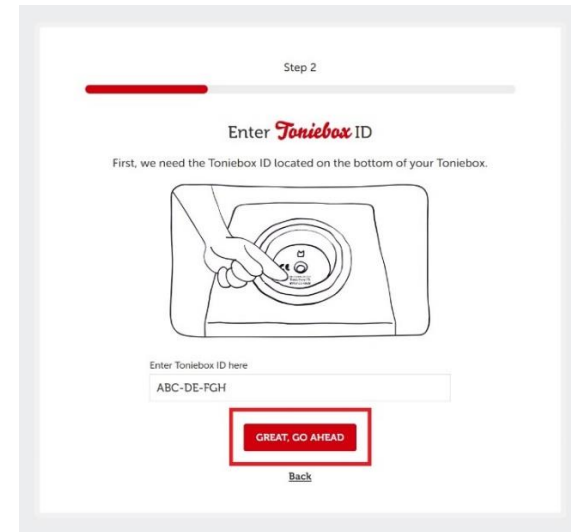

3. Turn on the Toniebox and pinch both ears for about 5 seconds until you hear an audio chime and the LED begins to flash blue. Wait for about 20 seconds until you hear a second audio chime. Then click on 'Then get started!'.

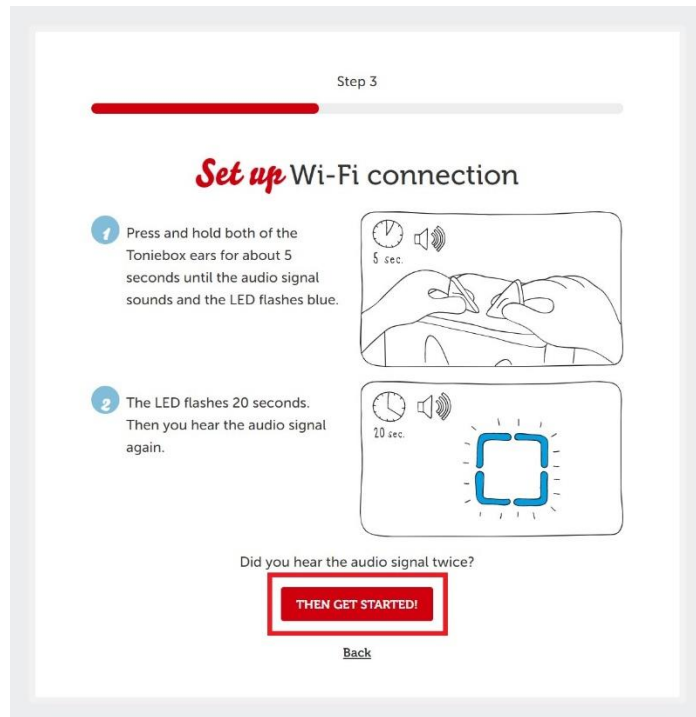

4. Now you will need to connect to your Toniebox. This is done by using a specific Toniebox WiFi network. Please note that this is different than your regular home WiFi network that we will connect to in a future step.

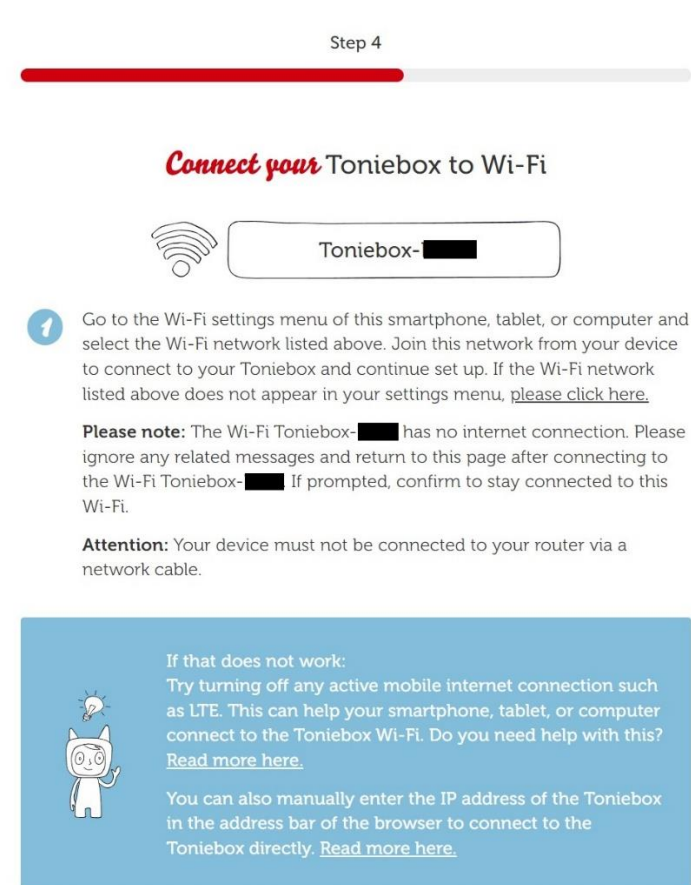

5. To connect to the Toniebox WiFi network, bring up the Network list on your device. In most cases, you can do this by clicking on the WiFi icon on the bottom-right of your screen.



6. Find the "Toniebox-####" network in the list of Wi-Fi connections. The last 4 numbers of the connection name will be different for every Toniebox. Click on the Toniebox network name and then click 'Connect'.

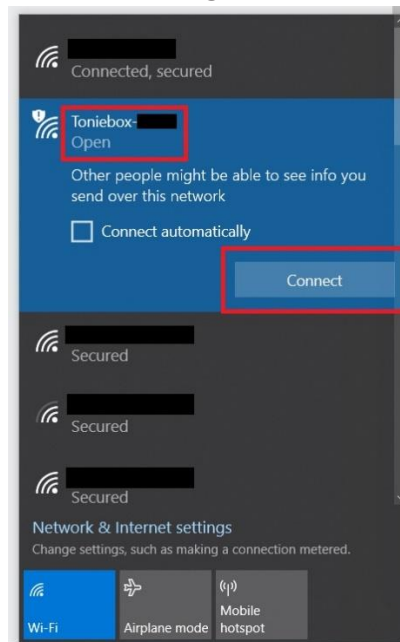

7. Once the connection with your Toniebox is established, open the webpage again and a new button will appear. Click 'Continue' to move forward.

Step 4



*Connect your* Toniebox to Wi-Fi



Toniebox-███

- 1 Go to the Wi-Fi settings menu of this smartphone, tablet, or computer and select the Wi-Fi network listed above. Join this network from your device to connect to your Toniebox and continue set up. If the Wi-Fi network listed above does not appear in your settings menu, [please click here](#).

**Please note:** The Wi-Fi Toniebox-███ has no internet connection. Please ignore any related messages and return to this page after connecting to the Wi-Fi Toniebox-███. If prompted, confirm to stay connected to this Wi-Fi.

**Attention:** Your device must not be connected to your router via a network cable.

- 2 Have you connected your smartphone, tablet, or computer to the Toniebox-███?

CONTINUE

If that does not work:

Try turning off any active mobile internet connection such as LTE. This can help your smartphone, tablet, or computer connect to the Toniebox Wi-Fi. Do you need help with this? [Read more here](#).



You can also manually enter the IP address of the Toniebox in the address bar of the browser to connect to the Toniebox directly. [Read more here](#).

8. Now you will connect to the new 2.4GHz WiFi connection. If the WiFi network is not already selected, you can click the dropdown arrow to view all nearby available WiFi connections. Click the name of the WiFi network and then enter the WiFi password. Once you have entered the correct password, click 'Connect Toniebox'.

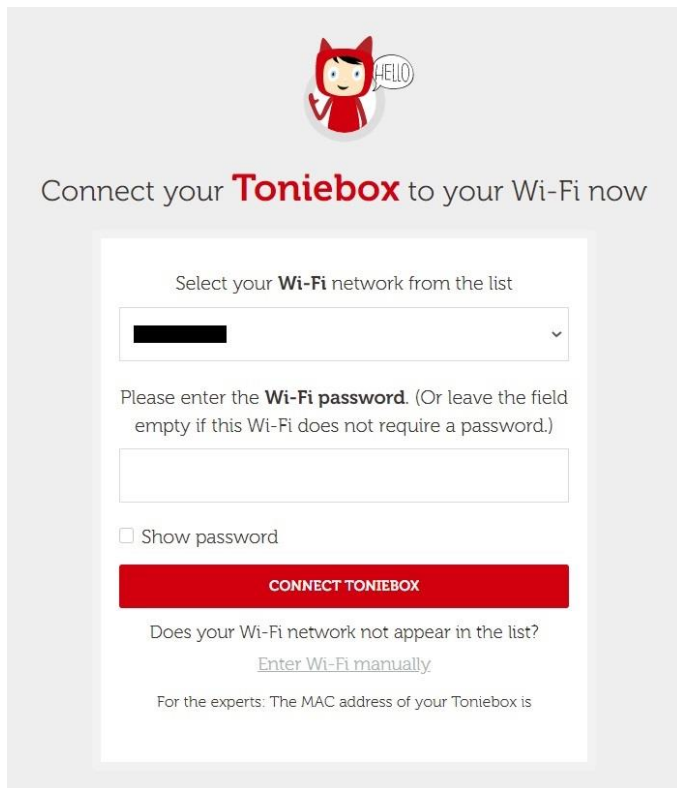

The image shows a screen for connecting a Toniebox to a Wi-Fi network. At the top is a small cartoon cat character with a speech bubble saying "HELLO". Below it, the text reads "Connect your **Toniebox** to your Wi-Fi now". The main content area is a white box with a grey border. Inside, it says "Select your **Wi-Fi** network from the list" above a dropdown menu. Below the dropdown, it says "Please enter the **Wi-Fi password**. (Or leave the field empty if this Wi-Fi does not require a password.)" above a text input field. There is a checkbox labeled "Show password". Below these is a red button with the text "CONNECT TONIEBOX". At the bottom of the white box, it says "Does your Wi-Fi network not appear in the list?" followed by a link "Enter Wi-Fi manually". At the very bottom, it says "For the experts: The MAC address of your Toniebox is".

9. Please wait while the Toniebox establishes a connection with the Wi-Fi.



10. Once the connection is successfully established, you will see a message on screen informing you that the connection with the new Wi-Fi was successful!

You made it!

### *Congratulations*

Your Toniebox is ready now. On **mytonies** you can easily add your own content to your Creative-Tonies or start with the little story we left for you [here](#).



If you have any questions please  
contact the Mukwonago  
Community Library at  
262-363-6411.  
Have fun using the Toniebox!